

Devon&Devon

NEW YORK

design **Paola Ciarmatori**

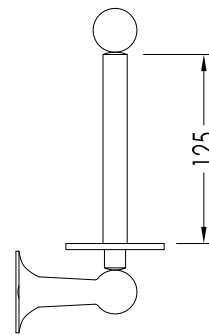
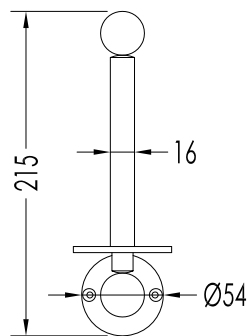
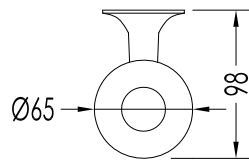

NY111CR/PS; NY111OT/PS; NY111NK/PS

- ▶ PORTA ROTOLO DI SCORTA
- ▶ MATERIALE: ottone
- ▶ FINITURA: cromo, oro chiaro o nickel lucido
- ▶ TOLLERANZA: $\pm 2\%$

N.B. Tutte le misure sono in millimetri. Questo disegno è di proprietà Devon&Devon.
Non può essere riprodotto o trasmesso a terzi senza autorizzazione.

- ▶ SPARE TOILET ROLL HOLDER
- ▶ MATERIAL: brass
- ▶ FINISH: chrome, light gold and polished nickel
- ▶ TOLLERANCE: $\pm 2\%$

N.B. All measurements are in millimetres. This drawing is property of Devon&Devon.
It may not be reproduced or transmitted to third parties without authorization.